

**How to automate
my Tuya smart
devices?**

060 319 2282 (MTN) or WhatsApp
072 604 4306 (Vodacom) or
WhatsApp
sales@henractech.co.za



Step 1

Go to the Tuya smart apps and then select the scene icon at the bottom left-hand corner.

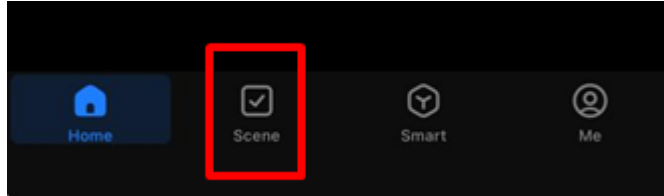

Step 2

Tap on the '+' symbol and then select **create scene**.

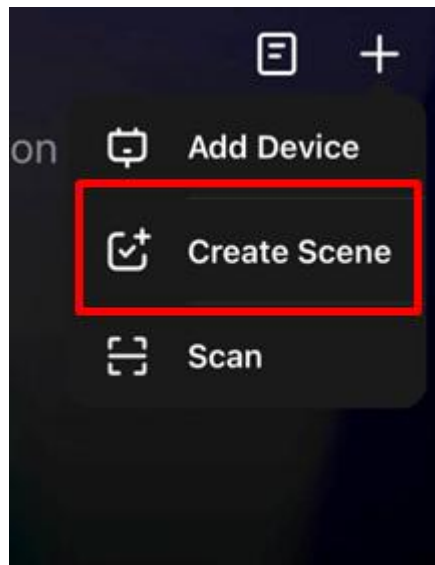

Step 3

Select any of the triggers that you would like for your automation to start.

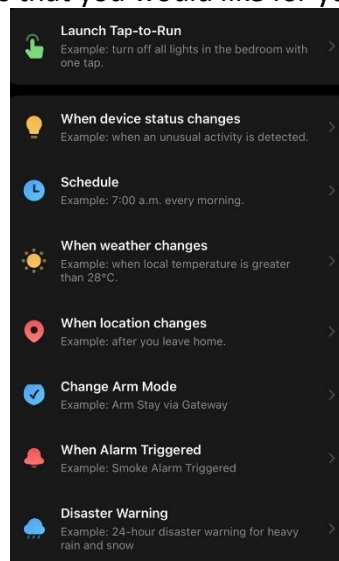

Explanation of each trigger

- **Tap-to-run:** this is a trigger that will start your automation once you have tapped it.
- **When device status changes:** this is a trigger that will start your automation once one of your smart devices changes its status.
- **Schedule:** this is a trigger that will start your automation on a schedule and time.
- **When weather changes:** this trigger will start your automation based on your location on the smart app.
- **When location changes:** this will trigger once your smart app detects that your phone is out of range of the location.
- **Change arm mode:** this trigger will start your automation once your smart device, like a smart security panel, has been changed to any of the arm modes.
- **When alarm triggered:** this trigger is when one of your smart security devices has gone off that which must start the automation.
- **Disaster warning:** the trigger will start the automation when it has detected a weather change, like heavy rain.

Using 'when the weather changes' and 'disaster warning' triggers

When using the '*when the weather changes*' and '*disaster warning*' triggers. You will need to make sure that your smart app is detecting the right area. In the smart app, you will see that the app has a weather tab where you can view the temperature, humidity, and pollution in your area.

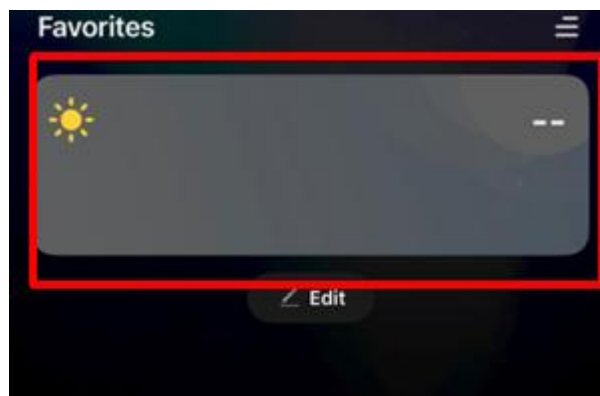

Tap on the weather tab and select your address or the area you are staying in. This will allow the '*when the weather changes*' and '*disaster warning*' to start the automation.

Using 'when location changes'

To use the '*when location changes*', allow your smartphone to share your location with the smart app so that it may run your automation.

Set up a timer for your smart device

There are two methods to set up a timer for your smart device.

Method 1: Set on the smart device

Step 1

Go into the Tuya smart app and tap on the smart device you would like to set a timer for.

Step 2

At the bottom of the screen, you will see the type of functions for the smart device. Tap on the timer icon.

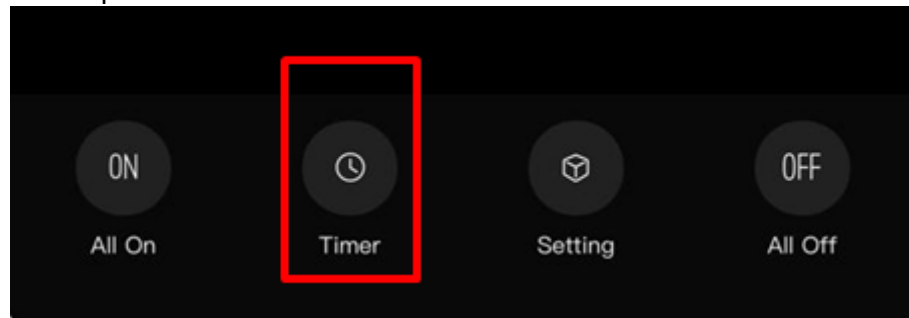

In the timer function, you will see that there are different ways of setting up a timer for the device.

Step 3

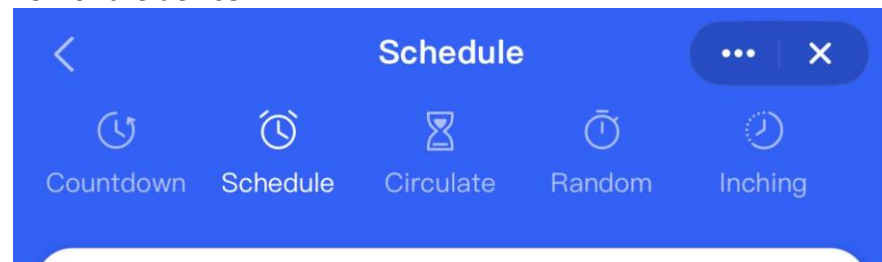

Explanations of each timer function:

- **Countdown:** is a digital clock that *counts down from a set time to zero*.
- **Schedule:** is when you would like the device to turn on and off.
- **Circulate:** will automate your device to switch on and off repeatedly on a preset schedule.
- **Random:** will randomly switch on the device.
- **Inching:** set how long the device must stay on before automatically switching off.

Method 1 is ideal when you have a lot of smart devices and would like to automate a scene based on one of the devices that has a timer on.

Method 2: Set up a smart scene

Step 1

Go to the Tuya smart apps and then select the scene icon at the bottom left-hand corner.

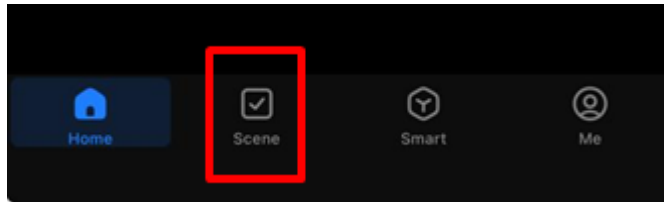

Step 2

Tap on the '+' symbol and then select **create scene**.

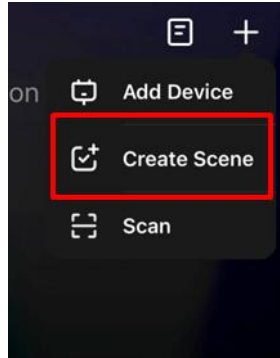

Step 3

Select the *Schedule trigger* to start the automation.

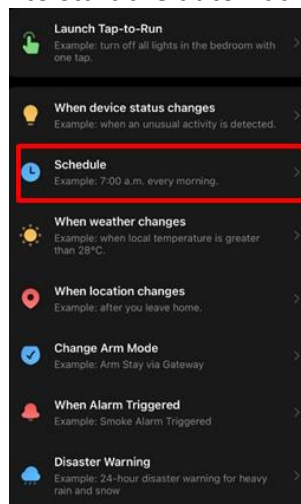

Step 4

In the *then* section, select devices.

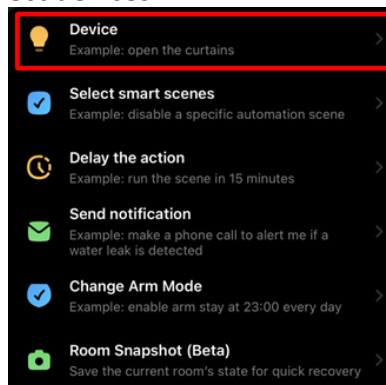

Then choose the smart devices you would like to switch on. Save the automation. Repeat the same steps to switch the smart devices off.

Method 2 works well for systems like the smart irrigation system.

Do use method 2 for your irrigation system. Use the inching timer on the smart relay switches and then create an automation scene. Add a delay action so that your irrigation controller does not switch on all of the zones at the same time.